

## Pulsar Digital LRF N850 Digital NV Riflescope

The Digisight LRF N850/N870 riflescope is designed for observation and shooting in twilight or night time. In complete darkness (no stars or the Moon) use of the built-in IR (or laser) Illuminator with 780nm wavelength (visible range) or 915nm wavelength (invisible range) is highly recommended. The riflescope is equipped with a *built-in Rangefinder* with a working measuring range of 400 metres. Your riflescope is a versatile device designed for a wide range of professional and amateur applications such as hunting, sports shooting, night video recording and observation. Range of detection to 600m (object 1.7m high )



### Integrated Laser Rangefinder

Extra precise shooting requires an exact knowing of distance. Integrated laser rangefinder with range up to 400 m allows to measure distance in single measuring mode and in scanning mode with precision up to +/- 1 meter.



### THD & AoE

In the conditions of changeable landscape, when shooting from high stands it is recommended to use THD (True Horizontal Distance) measuring mode - in this mode the Rangefinder, taking into account angle of shooter's elevation relative to a target (AoE; its value is also displayed on the screen) calculates true horizontal distance to an object.



### Selectable Reticles

A reticle is electronically displayed on the screen and is permanently located in the plane of target image. The Digisight LRF's internal memory contains 13 reticles of various shapes and applications. The central part of the reticles is illuminated; colour can be changed from red to green. The colour of the main part can be switched from black to white.



### Eyesafe Eye Relief

The Digisight riflescopes feature a 67 mm eye relief – one of the best parameters in its class. The greater the eye relief the less traumatic is the use of the scope, especially on hunting weapons with considerable recoil.



### 3 types of zeroing parameters memorization

The software allows the user to save in riflescope's memory three points of impact for three various distances (types of weapon or cartridges) and each option allows the use of a dedicated reticle. The horizontal and vertical numeric coordinates of the reticle position facilitates windage/elevation adjustments and completes memorization function.

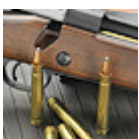

### High shock resistance

The Digisight LRF riflescopes feature high shock resistance and can be used with rifled hunting weapon for such cartridges as 9.3x64, .30-06, .300, .375. etc and with smooth-bore and air soft weapon.



### Variable magnification

Magnification provided by optic and software parts of Digisight LRF, makes up 4.5-9x. Magnification changes gradually, available magnification range consists of 10 steps (division value is less than 0,5x). Zoom value is displayed in the status bar in the bottom part of the screen.

## Pulsar Digital LRF N850 Digital NV Riflescope

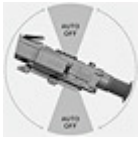

### **Energy saving modes. Automatic shutoff function**

When a weapon with a riflescope is in inclined position of 70° vertically and 30° horizontally (for more than 10 seconds) in any direction the riflescope will turn off. For energy saving and cases when video from the riflescope is not recorded there is also a possibility to turn off video out module. Both these functions can be activated in the menu of the riflescope.



### **Rifle inclination angle**

When rifle is inclined horizontally for an angle of more than 5 degrees a warning sign appears – compound arrows with indication of direction and incline level. The more lines in the compound arrow the greater is the angle of side incline.



### **Zeroing with FREEZE function**

Standard for Digisight riflescopes “one shot zeroing” in Digisight LRF models is complemented by an even more convenient zeroing function - “Freeze”. Now after making a zeroing shot it is enough to save a frame of a target in the memory of the riflescope and align reticule with point of impact looking at this frame without the necessity of keeping full immobility of a weapon.



### **Wide operating temperature range**

Ability to operate in normal mode at sub-zero temperatures is due to the use of a frost-resistant OLED display featuring fast response and provides crisp image when observing dynamic object.



### **Large detection distance**

Depending on modification Digisight LRF riflescopes provide more than a half kilometer detection distance for object 1.7x0.5 m. in size.



### **Video Out**

The Digisight LRF riflescopes are equipped with a Video Out jack enabling real time video recording with the use of external recording equipment.



### **External power supply**

Operating time can be significantly prolonged thanks to the use of high-capacity external power supply units attached to the Digisight via an External Power jack. During extended use in freezing weather, the external power supply units can be stored under the operator's clothes via an included extension lead.



### **Wireless remote control**

The wireless remote control allows basic operations to be fulfilled without resorting to standard controls.



### **Rifle mount**

The mounting holes in the base of the riflescope enable the mount to be installed in one of multiple positions. This choice (depending on the rifle type, anthropometric data of a shooter, etc.) helps the user to ensure the most suitable position on a riflescope



### **Night and Day Vision**

Night or ‘pitch black’ environments with a built in range finder to broaden its versatility. In this unconventional riflescope, a monochrome digital screen replaces the familiar direct optical path from the object to the eye.





## Pulsar Digital NV Riflescope LRF N850

### **Specification:**

#### **Electronic components**

Sensor type CCD  
Camera resolution 500 x 582 pixels  
Display type - OLED  
Display Resolution VGA 640 x 480 pixels  
Video OUT availability analog

#### **Optical characteristics**

Magnification 4.5x...9x  
Lens focus F50/1.0 mm  
Field of View horizontal 5/ 2.4 °  
Resolution 55 lines per mm  
Minimum focusing distance 5.5 m  
Eye Relief 67mm  
Exit Pupil 6mm  
Dioptre adjustment - 4 ... + 4

#### **IR-illuminator**

Emitter : Laser  
IR Wavelength 780 nm  
Range of detection 600m (object 1.7m high, illumination level 0.05 lux (1/4 moon))

#### **Power Supply**

Power Supply, V 4 ÷ 6  
Battery type 4xAA  
Battery Life hour 4/ 3.5 (w/out IR),  
External Power Supply - DC 8.4 ÷ 15V / 3W

#### **Built-in laser rangefinder**

Max. Measuring range 400m  
Measuring accuracy +/- 1 m  
Laser wavelength 905nm

#### **Reticule**

Windage & Elevation - 1 click (H/V) - 13 / 13 mm@100m  
Click range 1040 / 1300mm@100m H/V  
Reticule colour T-shaped, with illuminated red/green dot

#### **Physical & operational characteristics**

Shock resistance on rifled weapon - 6000 J  
Dimensions 340 X 1093, 112 X 1093, 94mm  
Weight 1 kg (without batteries)

Not for Export Only supplied within Australia  
For price & availability please call or send us an email

GSR Laser Tools, Unit 7 / 7 Prindiville Drive, Wangara WA 6065, Ph: 08 9409 4058

[sales@gsrlasertools.com.au](mailto:sales@gsrlasertools.com.au) [www.gsrlasertools.com.au](http://www.gsrlasertools.com.au)

## Thermal Rifle Scope Pulsar Apex XD50

The ultimate choice

Upgraded latest version

Following on from the success of the stunning Pulsar Quantum range of hand held thermal imagers, the new Pulsar Apex Thermal Imager riflescopes are set to take the night vision riflescope market by storm.

With a detection range of up to 1100m (XD50 man sized object) the new Pulsar Apex XD50 Thermal scopes will revolutionise the way we hunt at night.

The bigger brother of the Pulsar Apex XD38 thermal scope, the brand new Pulsar Apex XD50 thermal riflescope is designed for extreme long range vermin control allowing you to detect objects (measuring 1.7m x 0.5m) out to over 1km away, and provide high quality imagery at long distances.

At the core of a Pulsar Apex is a highly sensitive Amorphous Silicon (a-Si) thermal sensor, developed and manufactured in France by major NATO supplier ULIS.

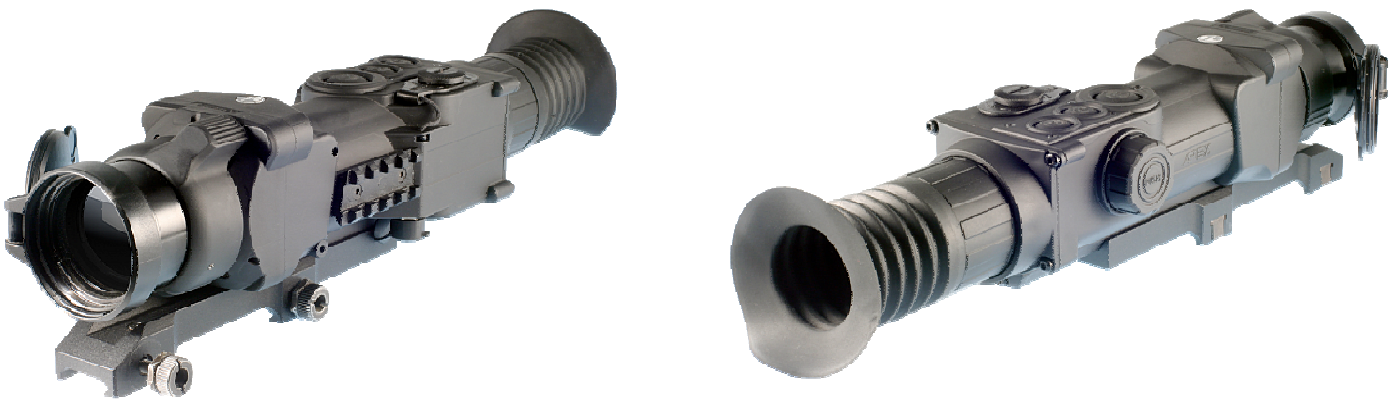

Unlike traditional night vision the new Pulsar Apex XD50 Thermal rifle scope is not impeded by weather conditions such as rain, fog, moisture etc which plays havoc with ir illuminators, scattering light everywhere and obscuring the image.

The high specification thermal microbolometer core is also unimpeded by objects such as grass or foliage, allowing you to spot quarry which has moved into cover.

Choose from 13 user selectable reticles, and attach the Apex XD50 Thermal to your riflescope using a traditional weaver rail, providing complete accuracy in weapons up to 6000 joules muzzle energy (in excess of .308) with a 50hz core to provide motion lag free imaging, even on running quarry such as boar or rats etc.

Memorisation of zero parameters allowing you to swap between weaver railed rifles without need to rezero (depends on quality of tolerance of weaver rail, and correct return to zero point application of mount to rail)

### Highlights :

- Long detection range
- Variable magnification
- Anti-shock sensor protection system
- Large eye relief
- Variable electronic reticles ( 13 types)
- High contrast image (OLED display)
- Simple adaption to different types of shooting (3 basic modes)
- Noiseless calibration
- Video output
- Wide range of operating temperatures
- External power supply
- Variable electronic reticles
- High frame rate 50Hz

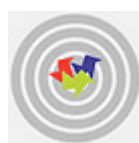

### Selectable Reticles

A reticle is electronically displayed on the screen and is permanently located in the plane of target image. The Apex internal memory contains 10 reticles of various shapes and applications. The colour of the reticle can be switched from black to white.

Not for Export  
Only supplied within Australia  
For price & availability please call